

OPORD 18-70

Reference: Map, South Vietnam; 1:100,000, Series L607, Sheet 6736

Task Organization: 1-12 Infantry

1. (C) SITUATION

- a. Enemy Forces: Current Bde INTSUM
- b. Friendly Forces: Current Bde SITREP
- c. Attachments and Detachments: See Task Organization

2. (C) MISSION

1st Bn, 12th Infantry moves by motor from Camp Radcliff to Camp Granite and prepares for redeployment.

3. (C) EXECUTION

- a. Concept of Operations:
 - (1) Maneuver: 1-12 Infantry moves to Camp Granite and Cha Rang at 040000 Nov 70, with an advance party and three march units and prepares for redeployment. (See Annex A- Road Movement Table.)
 - (2) Fires: Gunships and TAC AIR on call. FAC overhead during road movement. Priority of fires to unit in contact.
- b. Coordinating Instructions:
 - (1) Each march unit commander will insure that all of his vehicles are sandbagged on 03 Nov 70.
 - (2) All personnel will wear steel helmets and flak jackets during movement.
 - (3) All transportation whether organic or attached, which is allocated for the road movement to Camp Granite (MU #1&2) or to Cha Rang (MU #3) will be assembled in the 1-12 Inf motor pool on 3 Nov 70. The Bn S4 is responsible for dispatch of this transportation, as required. Company commanders will request vehicles required for the decorations and awards ceremony from the Bn S4. Upon arrival back to the 1-12 Inf motor pool of all vehicles required for the ceremony, march unit commanders will then coordinate with Bn S4 for the number and type of vehicles required for their march unit and align their march units as depicted at Appendix 1 to Annex A.
 - (4) Baggage will be tagged and loaded on S&P vehicles on 03 Nov 70. Baggage for all personnel in the 3d march unit will be retained by individuals and loaded on 5 ton vehicles on 04 Nov 70.
 - (5) All troops will be loaded and prepared to SP by 040730 Nov 70.
 - (6) All troops will face toward the outside of the vehicles during movement.
 - (7) March unit #3 will stop at Cha Rang to turn in equipment. Personnel will stay at Cha Rang until units equipment has been accepted and turned in. (See Annex D - Logistics.)
 - (8) Ammo and individual wpns will be turned in at Camp Granite for 1st and 2d march units and at Cha Rang for 3d march unit.
 - (9) Convoy will not stop at the Ponderrosa

4. (C) SERVICE SUPPORT

- a. Administration: (See Annex C)
- b. Logistics: (See Annex D)
 - (1) Each man will be supplied with one meal of C-rations for movement.
 - (2) Three bandoleers of ammo per individual on the convoy.
 - (3) Bn S4 will provide tags for baggage and coordinate turn over of trucks to CO cmdrs and MU cmdrs as required.

5. (C) COMMAND AND SIGNAL

- a. Signal:
 - (1) Current SSI, SOI in effect.
 - (2) All march units will monitor Bn command net.
 - (3) Convoy frequencies - (See Annex F - Signal.)
- b. Command: Bn CO will be heliborne during road movement. Bn CP(-) enroute in convoy and then at Camp Granite.

CONFIDENTIAL

Acknowledgments

SECRET
LTC

Annex A - East Movement Table
B - Strip Map
C - Admin
D - Logistics
E - Force Det
F - Signal

Distribution: Special

OFFICIALS

2/2/50
100350

83

CONFIDENTIAL

C O N F I D E N T I A L

Copy 1 of 40 Copies
HQ, 1st Bn, 12th Inf
Camp Radcliff, RVN
261500 Oct 70

ANNEX A (Road Movement Table) To OPORD 18-70

Reference: Map South Vietnam: 1:100,000, Series L607, Sheet 6736

1. Formation: Open Column (100 Meters between Vehicles)
2. March Unit Gap: 10 Minutes
3. Convoy Speed: Open Road - 25 MPH; Bridges and Villages - 15 MPH; Catch up Speed - 30 MPH.
4. Halts: No Scheduled Halts (See Appendix 2 to Annex A.
5. Route: Base Camp to Junction of Highways QL 508 and QL 19.
6. Critical Points:
 - a. SP - RJ of Highway QL 508 and Highway QL 19.
 - b. CP # 1 - Bridge BR 538461
 - c. CP # 2 - Intersection QL 19 and QL 3A - BR 626472
 - d. CP # 3 - Bridge - BR 747387
 - e. CP # 4 - Bridge - BR 919322
 - f. CP # 5 - QL 19 and QL 1 - BR 984334
 - g. CP # 6 - QL 441 and QL 440 - CR 047255
 - h. RP - CAMP GRANITE - CR 039274
7. 3D March Unit will turn off at CHA RANG. No other stops are scheduled.
8. March Units:

CONFIDENTIAL

CONFIDENTIAL

MARCH UNIT	DTG	ORG & CMDR	No VEHICLES	FROM	TO	ROUTE	LOCATION of CRITICAL POINTS	ARRIVAL TIME	CLEARANCE TIME
1	040800 Nov	CMDR: Cpt Gothren Co B(-) Baggage Medics HHC(-) Co A(-)	6-5T 1-S&P 1-5T 1-5T 6-5T <u>14-5T</u> 1-S&P	CPR	CP GRANITE CRO39274	Hwy 19	SP-BR491455 CP1-BR538461 CP2-BR626472 CP3-BR747387 CP4-BR919322 CP5-BR984334 CP6-CR-047255 RP-Camp Granite	0800 0807 0826 0849 0917 0928 0946 0949	0803 0810 0829 0852 0920 0931 0949 0952
2	040815 Nov	CMDR: Cpt Nettles Co D(-) Baggage Medics Co D(-) Co E(-)	6-5T 1-S&T 1-5T 6-5T 4-5T <u>17-5T</u> 1-S&P	CPR	CP GRANITE CR 039274	Hwy 19	SP-BR491455 CP1-BR538461 CP2-BR626472 CP3-BR747387 CP4-BR919322 CP5-BR984334 CP6-CR-047255 RP- Camp Granite	0813 0820 0839 0902 0930 0941 0959 1002	0816 0823 0842 0905 0933 0944 1002 1005
3	040820	CMDR: Cpt Pierce Co A(-) Co B(-) Co C(-) Co D(-), Co E(-) Equip Baggage S4 S4 Mess Personnel Commo Personnel Tents Vehicle-Trailers	1-5T 1-5T 1-5T 1-5T 5-3/4T 1-5T 5-2 1/2T 1-5T 1-5T 1-5T 1-S&P 1-S&P <u>9-5T</u> 5-2 1/2T	CPR	CHA RANG BR935320	Hwy 19	SP-BR491455 CP1-BR538461 CP2-BR626472 CP3-BR747387 CP4-BR919322 RP 935320 CHA RANG	0826 0833 0852 0915 0943 0946	0829 0836 0855 0918 0946 0949

Reference:

HARRIS
LTC

Distribution: Special

OFFICIAL

[Signature]
HARRIS

43

Appendices: 1 - MI Assembly Areas
2 - Helio

CONFIDENTIAL

(Assembly Areas)
Appendix to Annex A to OPORD 18-79

(HQ's 1-12 Inf)

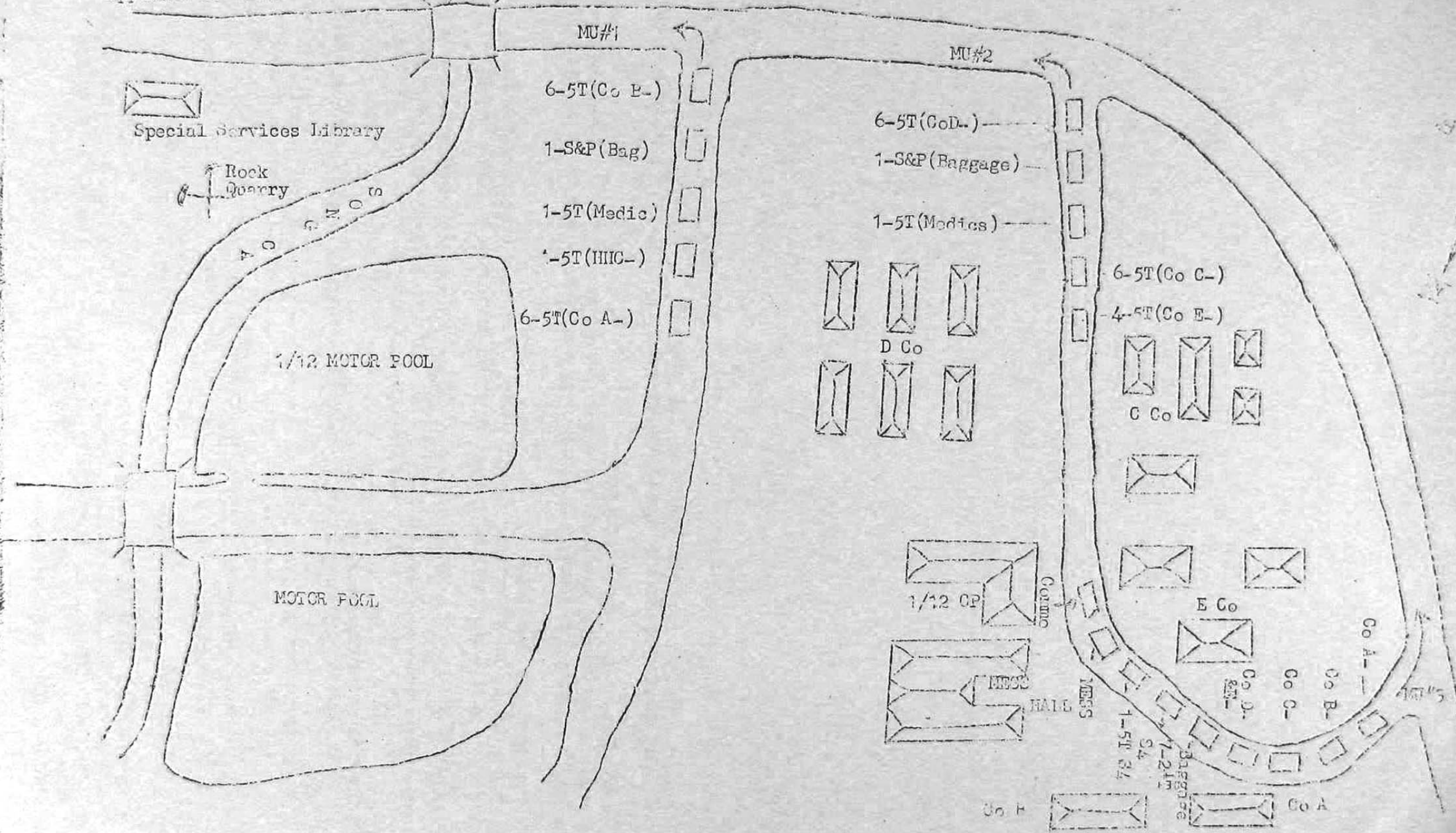

CONFIDENTIAL

Appendix Z: (HALTS) to Annex A, to OPORD 18-70 (HQ's 1-12 Inf)

HALTS DURING MOTOR MOVEMENT

1. There will be no scheduled halts on Highway 19. Emergency halts enroute may be made provided convoys are assembled in a secure area such as a group fire support base, or pump station along the highway.
2. Unavoidable, unscheduled halts will be conducted as follows:
 - a. All vehicles will pull to the far right side of the road but remain on the paved surface to permit traffic to pass unrestricted.
 - b. The convoy commander will place guards, warning flags, and lights or flares (security permitting) at the front and rear of the convoy.
 - c. The convoy commander will organize security around the halted convoy to prevent surprise attack.
 - d. The convoy will be closed to a vehicular gap of not less than 25 meters if ordered by the Security Force Commander to facilitate security command and control. Otherwise, the normal interval of 100 meters will be maintained.
 - e. Convoy personnel will stay in close proximity to their vehicles for control purposes and will wear the steel helmet, fragmentation jacket, and carry their weapons.
 - f. Escort gun-vehicle personnel will continue to man their automatic weapons and provide security for the halted convoy. These personnel will not dismount from their vehicles.
 - g. Indigenous personnel and vehicles will not be allowed to congregate around military vehicles or congest the highway.

CONFIDENTIAL

Copy 1 of 40 Copies
HQ's, 1st Bn., 12th Inf.
Camp Radcliff, RVN.
261500 Oct 70

Annex B (Strip Map) to O'ORD 18-70
Reference: Map South Vietnam, 1:100,000, series L607, sheet 6736
Strip Map not to scale

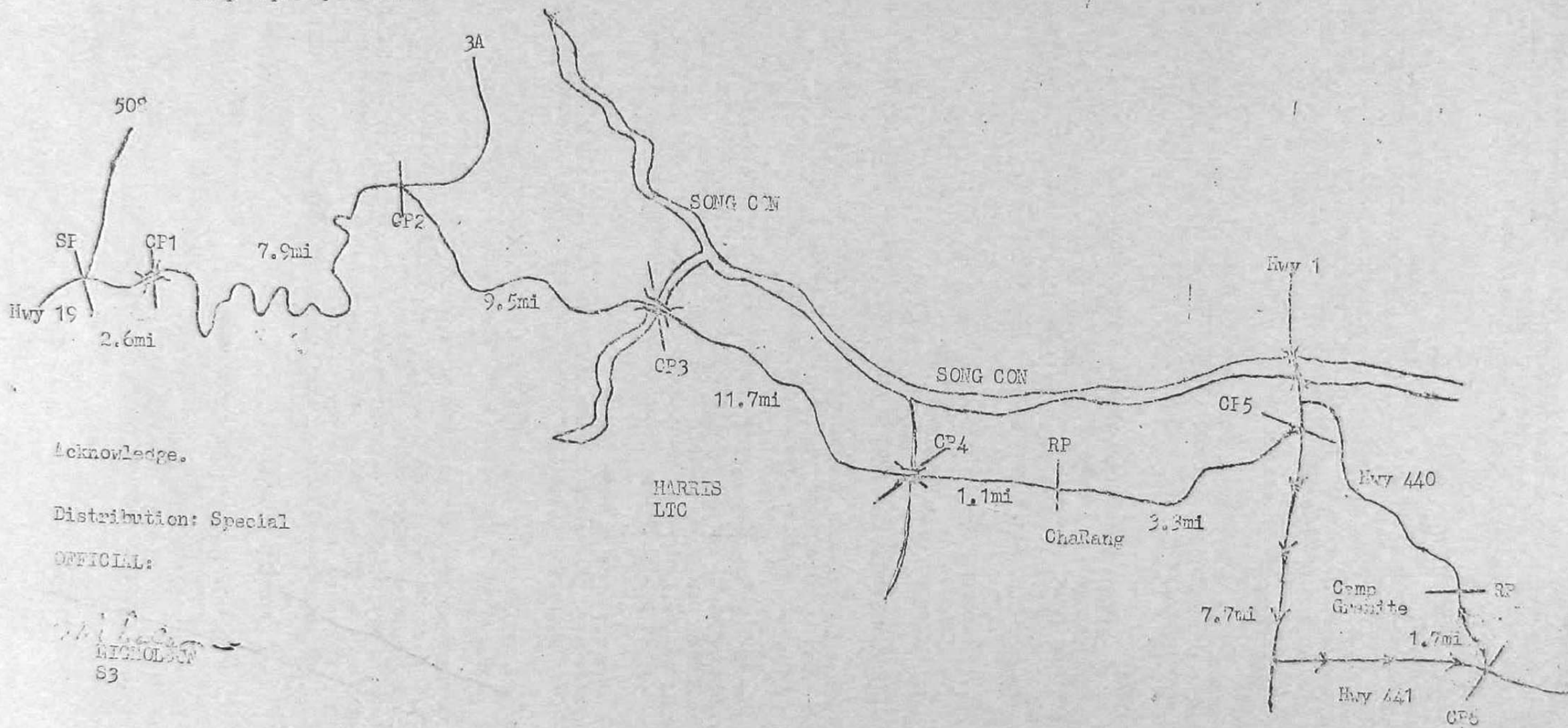

Acknowledge.

Distribution: Special

OFFICIAL:

Michael
MICHAEL
S3

CONFIDENTIAL

ANNEX C (Administration) to OPORD 18-70

1. PERSONNEL:

a. Maintenance of Unit Strengths:

(1) Strength Reports:

(a) Personnel Status Report: Strength Status Reports will be made to BN S-1, located at AG Central Personnel Control Center, Camp Granite, on a daily basis NLT 1800 hrs beginning on 4 November. Companies located at Camp Granite will fill out a status report (Appendix 1) and hand carry to S-1. Status Reports on personnel located at Cha Rang and Camp Radcliff will be made by telephone (CG 2964/2947). The OIC/NOIC of Cha Rang and Camp Radcliff are responsible for correct submission of reports.

(b) Personnel Daily Summary: PDS will be prepared by S-1, Camp Granite, on PSR and Bn totals reported to G-1 NLT 2000 hrs daily.

(2) Morning Reports: The responsibility for preparation of unit morning reports will be assumed by the AG Administrative Machine Branch one day prior to unit movement to Camp Granite.

(3) Rear Detachment: Rear Detachment will consist of three officers and 28 EM for roll up of Station property clearance. CO, HMC, is commander and exercises Article 15 jurisdiction over all Battalion personnel located at Camp Radcliff. R & R, Leave and TDY personnel returning to CRP after BN deployment will be sent to Camp Granite on first available means of transportation.

(4) Color Guard: Color Guard personnel will remain at Camp Radcliff after departure of Battalion. Color Guard personnel will be reassigned to 4th Tng Company, CPR, to conduct training for return to COMUS ceremony.

(5) Cha Rang: Cha Rang detail will consist of 7 Officers and 122 EM.

b. Personnel Management:

(1) Personnel Procedures:

(a) Out-processing Procedures: Out processing will be conducted in two phases. The first phase being initial processing (See appendix 2) immediately after assignment of billets and completion of weapons turn in. The second phase will be conducted on the day of departure (appendix 2). Rosters will be posted in the processing center establishing the reporting time for final process.

(b) Departure: After the final step in out processing, personnel will board a bus bound for Qui Nhon Army Airfield for onward transportation to the appropriate replacement battalion or new unit of assignment.

(2) Control of Personnel:

(a) Unit integrity will be maintained at all times. Non Commissioned officers will be assigned to billets with their personnel. Control of personnel will be the responsibility of the Unit Commander. Unit Commanders will organize and operate courtesy patrols throughout Camp Granite and will be responsible for the actions of the personnel of their unit. Unit commanders will be responsible for seeing that all personnel are present at all required formations.

(b) Unit Commanders will be tasked to provide detail personnel for Camp Granite support by the 4th Division Liaison Officer. Commanders will respond promptly to personnel requirements placed on them by the Liaison Officer.

(c) Company commanders, plt ldrs, and plt sgts will maintain a personnel roster reflecting status of each man in the unit.

ANNEX C (Administration) to OPORD 18-70

(c) Development and Maintenance of Moral:

(1) Postal: En Mail Clerks will receive mail from CPR Div APO IAW established schedules at the APO Office Camp Granite. Mail will be broken down as rapidly as possible and carried to companies by En mail clerks. Mail for personnel at Cha Rang will be forwarded from camp Granite to Cha Rang by daily courier. Mail for detail remaining at CPR will be hand carried forward by first possible means to CPR.

(2) Religious Activities: Protestant Chaplains and Catholic Priests will provide services on Sunday at Camp Granite at 1000 hrs for Protestant and 1115 hrs for Catholic.

(3) Special Services Activities: Mobile PX and Snack Bar are spotted at Camp Granite and Cha Rang Processing Centers. A NCO/EM Club is also available for troop use.

(d) Maintenance of Discipline, Law and Order:

(1) Discipline, Law and Order is a Command Function.

(2) A MP detachment is assigned to the Out Processing Center. Primary utilization is security of billet area. Secondary utilization is control of troop activities.

(3) Troop Conduct and Appearance:

(a) Maximum use of Command emphasis and supervision will be used to control conduct of troops. Large groups will not be allowed to assemble. No beer consumed from 0800 to 1700 hrs, and a limit of six cans of beer per man after duty hours. Curfew each night at 2230 hours lights out at 2300 hours.

(b) Personnel at all times will maintain a neat and proper military appearance. Anytime outside the billets personnel will have complete uniform (i.e. fatigue jacket, jungle boots, soft cap). Civilian attire is not authorized. Beehive caps are not to be worn at any time.

Acknowledge.

HARRIS
LTC

Distribution: Special

OFFICIAL
SOMMERS
S-1

Incl

- 1 - Status Report
- 2 - Processing Check List

Appendix II (out Processing Check List) to Annex C (plans) to OPORD 15-70
(10, 1/12 Inf)

Initial Processing

- Check individual's records
- Check MCT Currency Control Card, ID Card and Dog Tag
- Check shot record and issue necessary immunizations
- Partial, advance or advance travel pay
- Check finance records
- Check personnel records
- Prepare postal locator cards
- Manifest for flight

Final Processing

- Check and sign for medical, dental, personnel and finance records.
- Issue Military Travel Authorization (DD Form 1492).
- Issue transportation for airfield.

CONFIDENTIAL

Copy No 1 of 40 copies
HQ's, 1st Bn, 12th Infantry
Camp Radcliff, RVN
261500 Oct 70

Annex D (Logistics) to OPCODE 18-70

1. GENERAL

a. Camp Granite: The 1st Battalion 12th Infantry will be redeployed at Camp Granite in Qui Nhon. The S4 section will send advance party #1 that will arrive at Camp Granite on 3 Nov 70. The OIC (Lt Vance) will coordinate the turn-in of all M-16 rifles and flak vests after the arrival of the convoy on 4 Nov 70. This advance party will then depart Camp Granite at 1500 hrs with the rifles and flak vests for turn-in at the Keystone Robin facility at CHA RANG. The main body will then outprocess from Camp Granite.

b. CHA RANG: The order also provides for the turn-in of all equipment by 80 selected personnel at the Keystone Robin facility at CHA RANG. The S4 section will send advance party #2 to CHA RANG on 3 Nov 70 to coordinate the arrival of march unit #3. The OIC (Lt Provost) will supply guides to show turn-in personnel to their temporary quarters, work areas, and mess facilities. The OIC will also supervise the unloading and storing of all equipment from the convoy trucks.

2. MATERIAL AND SERVICES

a. Supply:

(1) Class I:

a. Each company will draw one C-ration meal per individual by 1200 hrs on 3 Nov 70 for the noon meal on 4 Nov 70.

b. A-rations will be served on 4 Nov 70 in the mess hall from 0330-0430 hours.

c. A-rations will be provided by Granite City and CHA RANG mess halls for all other meals.

d. Meal schedule at CHA RANG is breakfast: 0530-0630 hrs; dinner: 1145-1230 hrs; supper: 1830-1915 hrs; and night shift 2330-0015 hrs.

(2) Class II, IV:

a. Cleaning equipment: The Keystone Robin facility at CHA RANG will supply all necessary cleaning equipment. The S4 section will also transport extra cleaning equipment to CHA RANG.

b. Weapons:

(1) Commanders will insure each weapon is tagged with serial number and unit.

(2) Upon arrival in Granite City, all troops will remain in trucks, while unit commanders are briefed on weapon turn-in procedure. No one will leave the area until all weapons are turned in and a hand receipt is given to the unit commander. One company will be handled at a time.

(3) The weapon turn-in at CHA RANG will be handled in the same manner.

c. Flak Vests: One flak vest will be turned in with each M-16 rifle.

(3) Class V:

a. Upon arrival in both Granite City and CHA RANG, two men from each truck will stack all ammunition behind their truck. Personnel from the 581st Ammunition Battalion will collect ammunition.

b. An officer from each company will certify that all ammunition has been removed from both the troops and trucks. It is a federal offense to have any ammunition in the area after this certification.

(4) Class VI: Post exchange are operated in both CHA RANG and Granite City.

(5) Class VII: All major end items will be turned in at the Keystone Robin facility in CHA RANG.

(6) Class VIII: Medical peculiar items will be turned in prior to departure from Camp Radcliff.

(7) Class IX: All repair parts will be turned in prior to departure from Camp Radcliff.

b. Transportation:

(1) Advance party #1: This party will use two organic 2 1/2 ton trucks. It will depart Camp Radcliff at 0800 hrs 3 Nov 70 and arrive in Granite City at 0930 hours. At 1300 hrs on 4 Nov 70, the party will transport the battalion's M-16 rifles and flak vests from Granite City to CHA RANG. Also, PRC-25 radios, used during movement to Camp Granite and all organic vehicles (to include vehicle mounted radios) will be collected and taken to CHA RANG by advance party OIC.

CONFIDENTIAL

CONFIDENTIAL

(2) Advance party #2: This party will use one 3/4 ton truck. It will depart Camp Radcliff at 0800 hrs on 3 Nov 70 and will arrive in CHA RANG at 0900 hrs.

(3) Command and control vehicles for the convoy are: 1. Bn Co; HQ6; Bn S3, HQ3; cmdr MU #1, HQ3; cmdr MU #2, HQ46; and cmdr #3, HQ44. All vehicles will have vehicular mounted radios.

(4) Organic vehicles will provide transportation from the mess and billeting area to the work area in CHA RANG.

(5) The S4 section will use 14 5 ton trucks, one stake and platform trucks, and five organic 2 1/2 ton trucks for the move (Appendix 1 to Annex D).

c. Services:

(1) Individual will maintain personal clothing.

(2) Facilities available for turn-in detail at CHA RANG are: swimming pool from 1000-2200 hrs, and officer, NCO, and EM clubs.

d. Maintenance: Necessary maintenance will be performed at CHA RANG to meet turn-in standards.

3. MEDICAL EVACUATION AND HOSPITALIZATION

a. Current inoculations will be completed prior to 3 Nov 70.

b. Medical support at both CHA RANG and Granite City will be provided by 4th Medical Battalion.

4. PERSONNEL

a. Turn-in Detail: The 89-man turn-in detail (see Appendix 2 to Annex D) will be divided into two shifts. The day shift will work from 0630-1830 hrs, while the night shift will work from 1900-0600.

b. The S4 will submit a personnel status report to Keystone Personnel NLT 1700 hours on each day at CHA RANG.

c. Major Cook is OIC of all technical matters at the Keystone Robin facility while Major Williams is OIC of all administrative matters. Any questions in these areas should be forwarded to the right person.

Acknowledge.

HARRIS
LTC

Distribution: Special

OFFICIAL:

Pierce
PIERCE
S4

Appendixes: 1 - Cha Rang Detail (Personnel)
2 - Load Table

CONFIDENTIAL

CONFIDENTIAL

LOAD TABLE

Appendix 1 (Serial #3) to OFORD 18-70, 1-12th Infantry.

<u>LOAD</u>	<u>TRUCKS REQUIRED</u>
1. Baggage and personnel	5 -- 5 Ton
2. Bayonet, sensors, mine sweepers	1 - 2 1/2 Ton
3. Commo	3 - 2 1/2 Ton
4. Generators	1 - 5 Ton
5. Mess	2 - 5 Ton
6. Misc	5 - 3/4 Ton
7. Mortars	1 - 5 Ton
8. Protective masks	1 - 5 Ton
9. Saws, flame throwers	1 - 5 Ton
10. Tralers	1 - S&P
11. Water blivets	1 - 5 Ton
12. Weapons (M-16's, M-60's, M-79's, 45 cal)	1 - 2 1/2 Ton

TOTAL: 1 - S&P
 14 - 5 Ton
 5 - 2 1/2 Ton
 5 - 3/4 Ton

CONFIDENTIAL

CONFIDENTIAL

APPENDIX 2 (PERSONNEL CHART) to OFORD 18-70, 1st-12th Infantry
CHA RANG OIC Cpt Pierce, NCOIC SFC Black

	1	2	3	4	5	6	7
SECTION	WPNS	ARTY and FIRE CONTROL	SPECIAL PURPOSE and VEHICLE	MESS	COMMO	WASH PT	All other field desks, flags, etc
Overall OIC/ COIC - day IC/NCOIC	Lt Vance Sgt Rhode Sp4 Gill Sp4 Brown Sp4 Smith, J Sp4 Bluney Sp4 Bislex Sp4 Ferrell PFC Patten PFC Collins PFC Takopuc PFC Gibson	SSG Renya Sgt Anderson Sp4 Wollard PFC Clark	Lt Rush Sgt Reed Sp5 Rostwyk Sp4 Cornish Sp4 D'Jernes Sp4 Clark Sp4 Fisher Sp4 Radziewez Sp4 Conlon PFC Mc Mahon	SFC Morrison Sp5 White Sp4 Ford Sp4 Chapman PFC Rodgers	Cpt Johnson SFC Stockman Sp5 Armstrong	Sgt Watson Sgt Couchex Sp4 Champion Sp4 Truewell	SSG LaForge Sp4 Heredia Sp4 Stallbaumer PFC Bradley
Light OIC/ NCOIC	Lt Provost SSG Bustamonte Sp4 Dohman Sp4 Mammen Sp4 Dotz Sp4 Terrell Sp4 Brinkley Sp4 KirkPatrick PFC Franzel PFC Robles PFC Baker	SSG Mallo Sgt Fogle Sgt Stukes Sp4 Changelow	Sp5 Seccra Sp4 Vargas Sp4 Crockett Sp4 Stowe Sp4 Tucker Sp4 Leritz Sp4 Kiefer Sp4 Ayala	SSG Laconca Sp5 Wilson Sp4 Maloney Sp4 Comporet Sp4 Terhune	Sgt Coleman Sgt Deleon	Sgt Hobbs Sp4 Lamaison Sp4 Ncroin Sp4 Wilson	SSG Lewis Sgt Malek Sp4 Thomas Sp4 Vollmore

CONFIDENTIAL

CONFIDENTIAL

8

DOCUMENT TURN-IN

OIC/NCIC

CW-2 Duval
Sgt Gershoffer
Sp4 Banks

OIC/NCIC

SSG Hawes
Sgt Withers
Sgt Upton

Remarks
Drivers

Sp4 Wittenburg
Sp4 Hardee
PFC Vaughn

HQ 6
HQ 5
HQ 7 from 124th Trans

CONFIDENTIAL

Annex E(Rear Detachment) to OPOD 18-70

Reference: Map, South Vietnam; 1:100,00, Series L607, Sheet 6736

1. ORGANIZATION

a. Personnel:

(1) OIC - 1-Cpt (Cpt Smith)	HHC
(2) OIC(asst) - 1-LT (Lt Kidman)	HHC
(3) S2 - 1-LT (Lt Clements)	HHC
(4) NCOIC - 1-E7 (SFC Blackwell)	Co A
(5) Supply Sgt - 1-E6 (Sanchez)	HHC
(6) Detail Pers - 17 EM (colorguard)	Bn
(7) Detail Pers - 18 EM	2 ea, Co's A,B,C,D
(8) Drivers - 2 EM	4th S&T Bn
(9) Medic - 1 EM	HHC

2. EQUIPMENT

a. Vehicles: 2- 3/4T or 1/4T trucks 2-5 ton	1-12 Inf 4th S&T Bn
b. Brooms - (10)	
c. Diesel - (50 gal)	
d. Grass Cutters - (10)	
e. Off limit signs - (75)	
f. Hammers and nails	

3. OPERATIONS

a. Billeting: Initially, upon departure of the battalion, detachment personnel move into building #H-432, in the stand-down area. Subsequent to clearance of both the battalion main and battalion stand-down area, the color guard will move to the 4th Admin Co, until departure to CONUS. The rear detachment(-) will move by air to Qui Nhon for cut processing to their new units.

b. Messing: Rear detachment personnel will mess with the 4th Admin Co.

c. Communications: Commo will be via class A telephone in the stand-down area. Headquarters building, phone #2020. The class A phone will be operational until 6 November 1970.

d. Reports: Daily telephonic strength reports will be passed from rear detachment, to Bn S1, at Qui Nhon.

e. Property Turn-in:

(1) Station property left in the stand down area will be turned in by the rear detachment to DSO on 4 and 5 November.

(2) Buildings will receive a pre-turn in inspection by DPC personnel on 1 Nov 70. Buildings will be turned over to DPC on 6 Nov 70.

f. Units must accomplish the following, prior to departing the units stand-down area:

(1) Insure that all buildings are thoroughly policed, inside and out.

(2) Place all trash into trash barrels in the unit areas (only).

(3) Cut all grass in the unit area.

(4) Remove all tactical wire, rope, string etc from inside and around building. Note: Especially, strings and wire hanging from the rafters.

(5) Remove all papers, pictures, posters from the walls of buildings, both inside and outside.

(6) Burn all latrine cans until all waste is disposed of. Insure that all urinal screens are clear of debres.

(7) Insure that fire extinguishers are left in the buildings.

(8) Unit cmdrs will strike all tents in their unit area on the morning of 4 Nov. Tents will be neatly folded and placed on the cement block. Poles and pins will be neatly aligned with the tents.

(9) Company commanders will report accomplishment of the above to the Bn XO NLT 1600 hours 3 November 1970. (With the exception of item #8.)

Acknowledge.

HARRIS
LTC

Distribution: Special

OFFICIAL:

NICHOLSON

S3

CONFIDENTIAL

C O N F I D E N T I A L

Copy 1 of 40 Copies
HQ, 1st Bn, 12th Inf
Camp Radcliff, RVN
261500 Oct 70

Annex F (Communications - Electronics) to OPORD 18-70
Reference: Map, South VietNam, 1:100,000, Series L607, Sheet 6736

Command and Signal

1. Signal: Current SSI and SOI in effect, 4th Inf Div.
2. Command:

a. Use of Highway 19 tactical radio FM nets for coordination and control during the road march from An Khe. The Highway command Net frequencies are:

- (1) From An Khe to An Khe Pass - 44-90 - Callword: BIPLD MARGIN
- (2) From An Khe Pass to Bridge # 4 - 33.60 - Callword: RAINY BADMAN

b. Use of Battalion Primary FM Net for command and control of road march serials.

c. The Bn CO, S-3 and the three serial commanders will be provided with AN/PRC-46 radios. AN/PRC -25 radios are available if additional requirements exist. PRC -25 radios will be put into the last vehicle of each serial and also the S-3 vehicle.

d. At the Cha Rang Marshalling Area two commercial telephones are available for use. They are Cha Rang 185 and Cha Rang 178.

e. There are no land lines available at Cha Rang.

f. Communications between the rear detachment at An Khe and Camp Granite or Cha Rang will be by telephone. To call the rear detachment from Camp Granite or Cha Rang call AN KHE 2020.

g. Telephone numbers for Camp Granite will be disseminated at a later date.

Acknowledge.

HARRIS
ITC

Distribution: Special

OFFICIAL

NICHOLSON
S3

CONFIDENTIAL